

Shell Side Out

Make 2 - .125 thick
Cut inside profile .0625 deep

Bevel far side bottom edge 30 degrees
Bevel far side other 3 edges 45 degrees

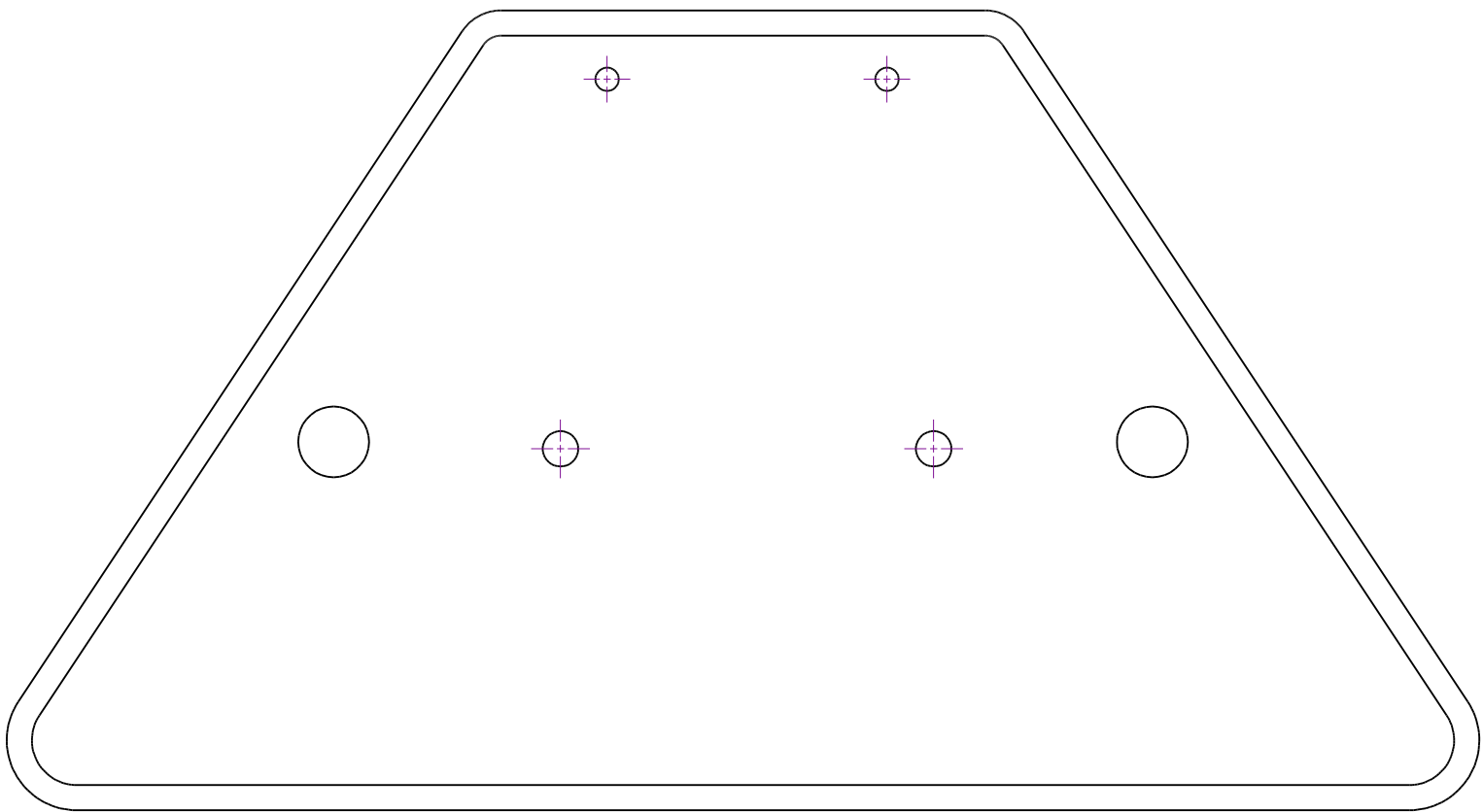

Shell Side In

Make 2 - .125 thick
Cut inside profiles .0625 deep
Holes with center marks + are thru holes

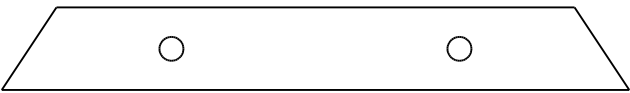

Shell Side Strip

Make 2 - .125 thick
Cut inside profile .0625 deep

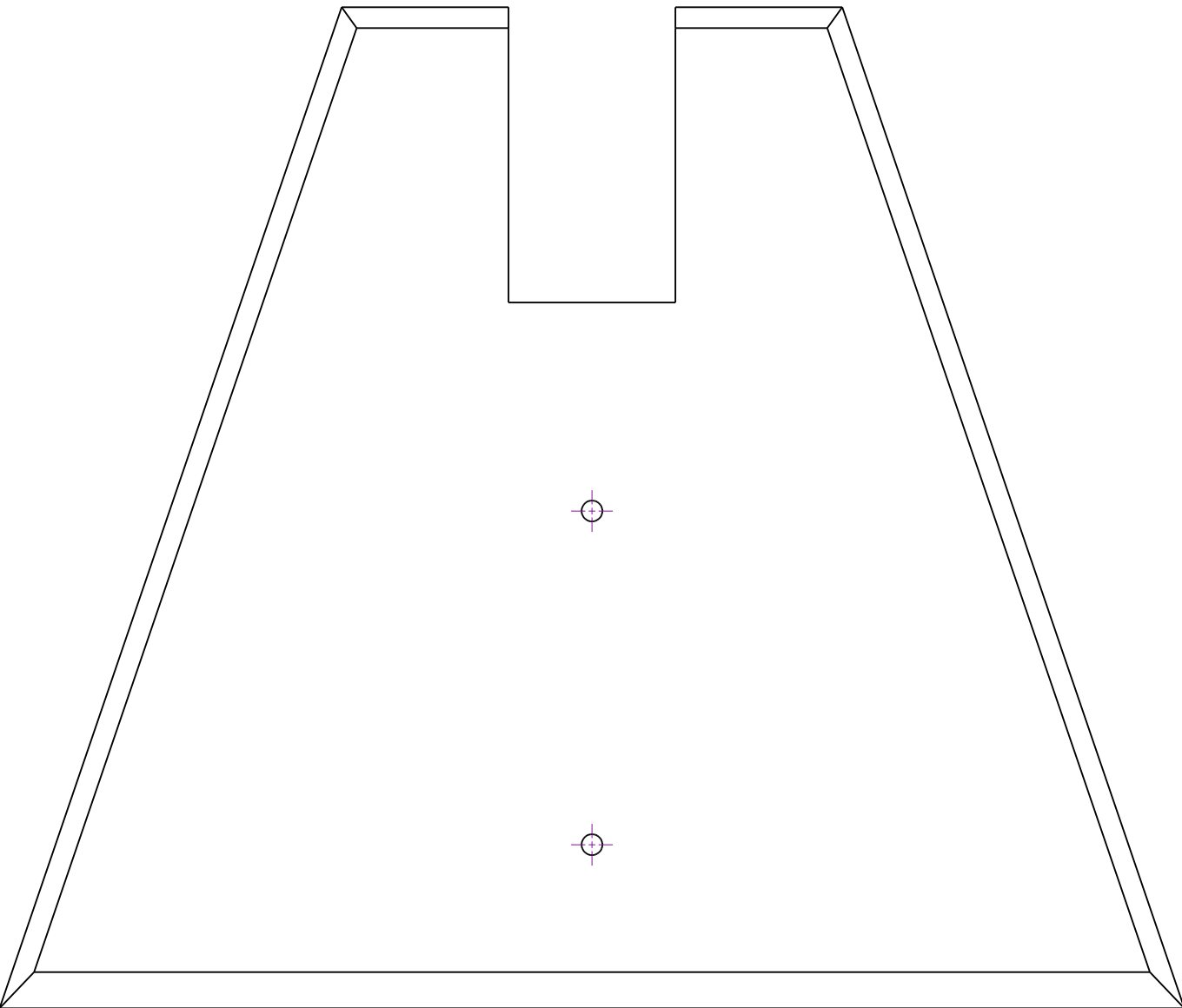

Shell End

Make 2 - .125 thick
Bevel edges shown 45 degrees
Holes with center marks + are thru holes

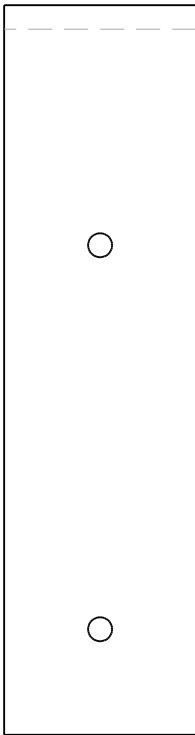

Shell End Strip

Make 2 - .125 thick
Cut inside profiles .0625 deep
Bevel far side edge 60 degrees

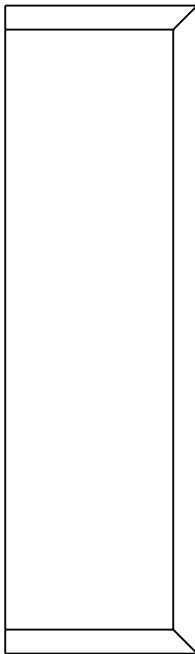

Shell Top

Make 2 - .125 thick
Bevel 3 edges 45 degrees

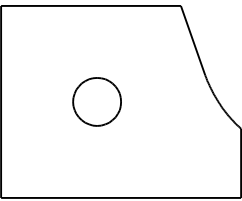

Ankle Lock

Make 8 - .125 thick

CS:R SAK Center Foot - V1
Shell Components

Copyright Media-Conversions - Released for non-commercial use ONLY!

DRAWN	DATE	<div>MediaConversions</div>			
CHECKED	03/01/17				
QA					
MFG					
APPROVED		SIZE	FSCM NO.	DWG NO.	REV
		C			
		SCALE		SHEET	

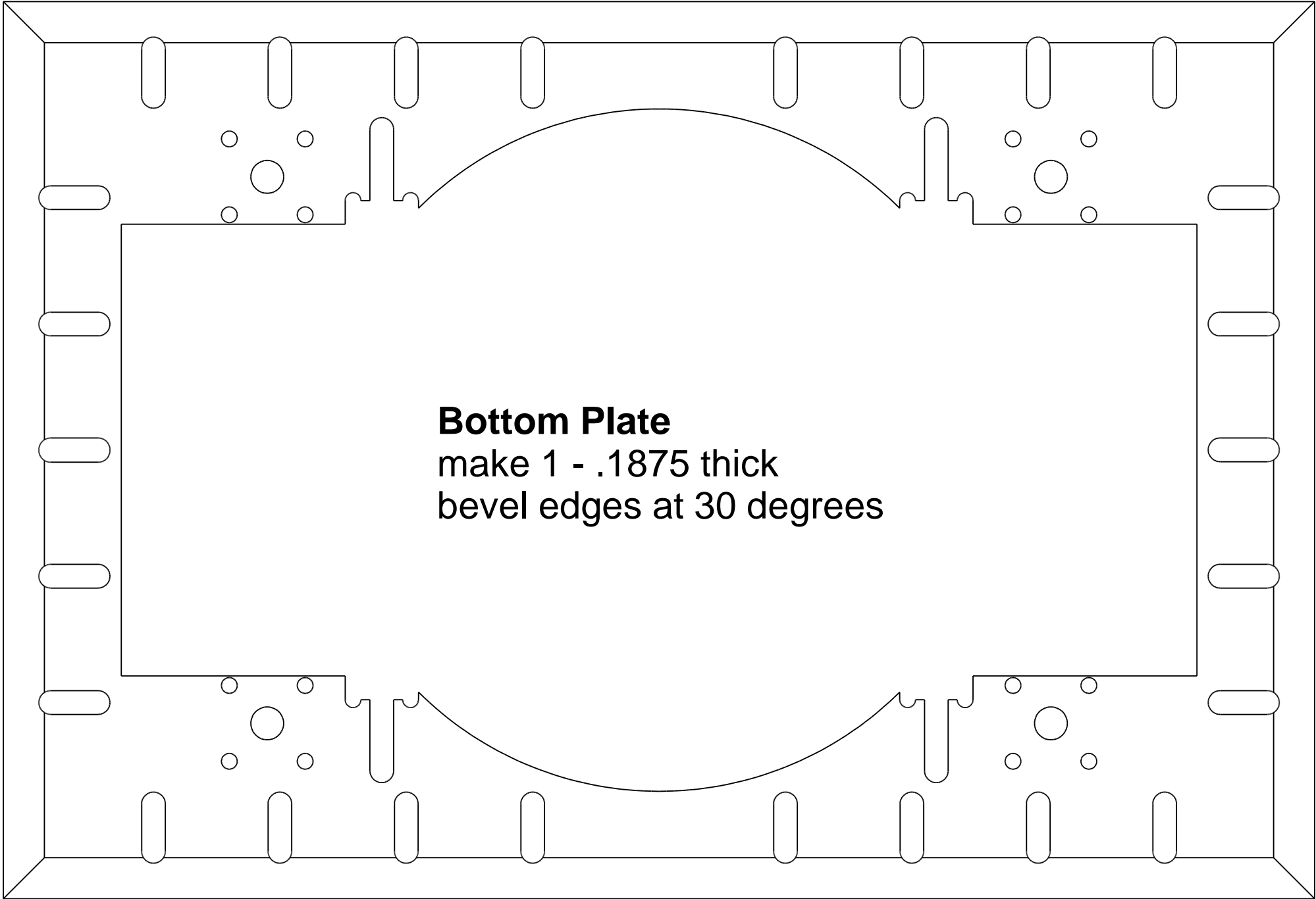

Bottom Plate
make 1 - .1875 thick
bevel edges at 30 degrees

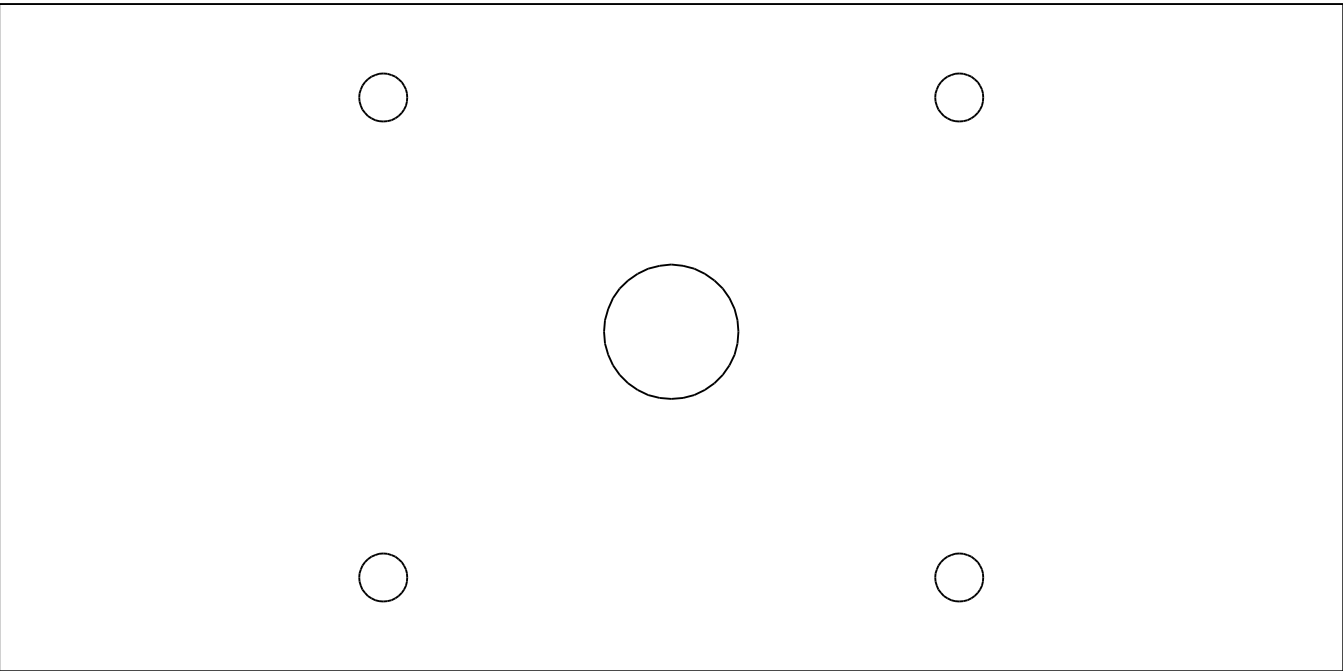

Load Spacer
make 1
.1875 thick

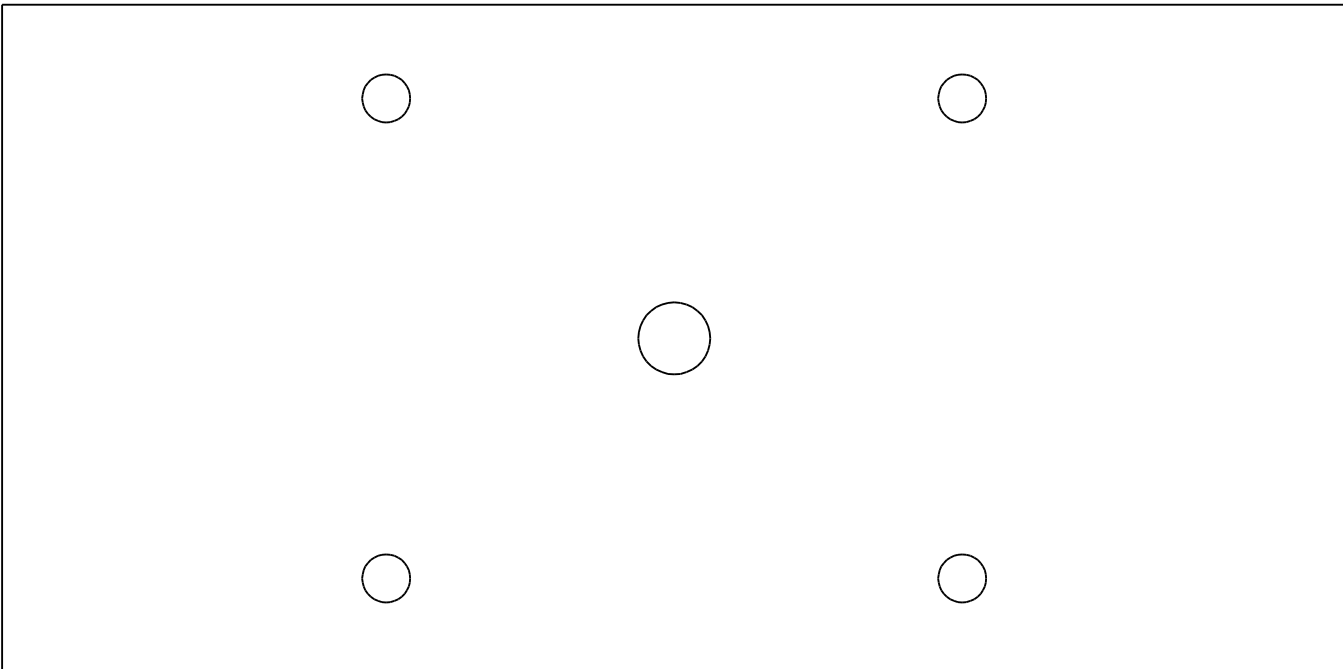

**Colson
Wheel Mount**
make 1
.1875 thick

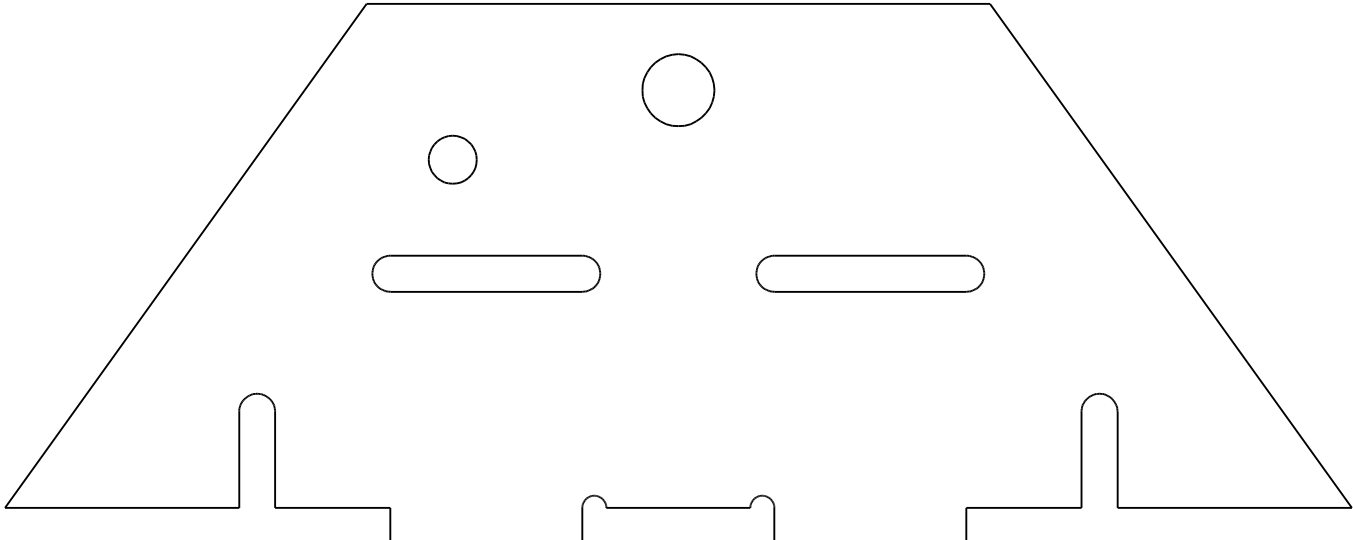

Bolt Panel
make 4 - .125 thick

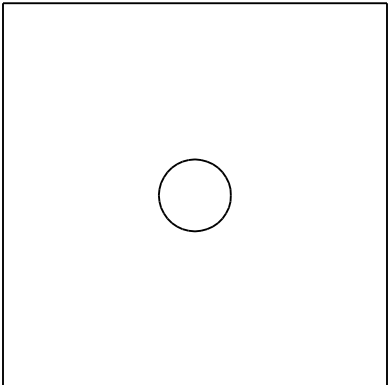

Caster Spacer
make 3 - .125 thick

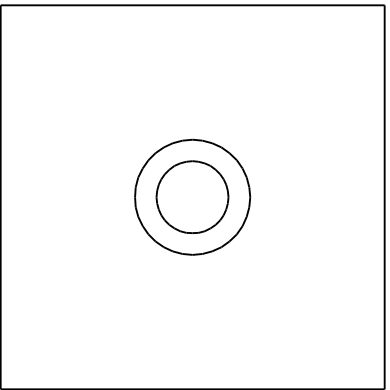

Caster Shoulder Spacer
Make 1 - .125 thick
Cut profile .05 deep

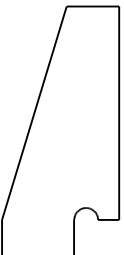

Apron Brace
make 26
.1875 thick

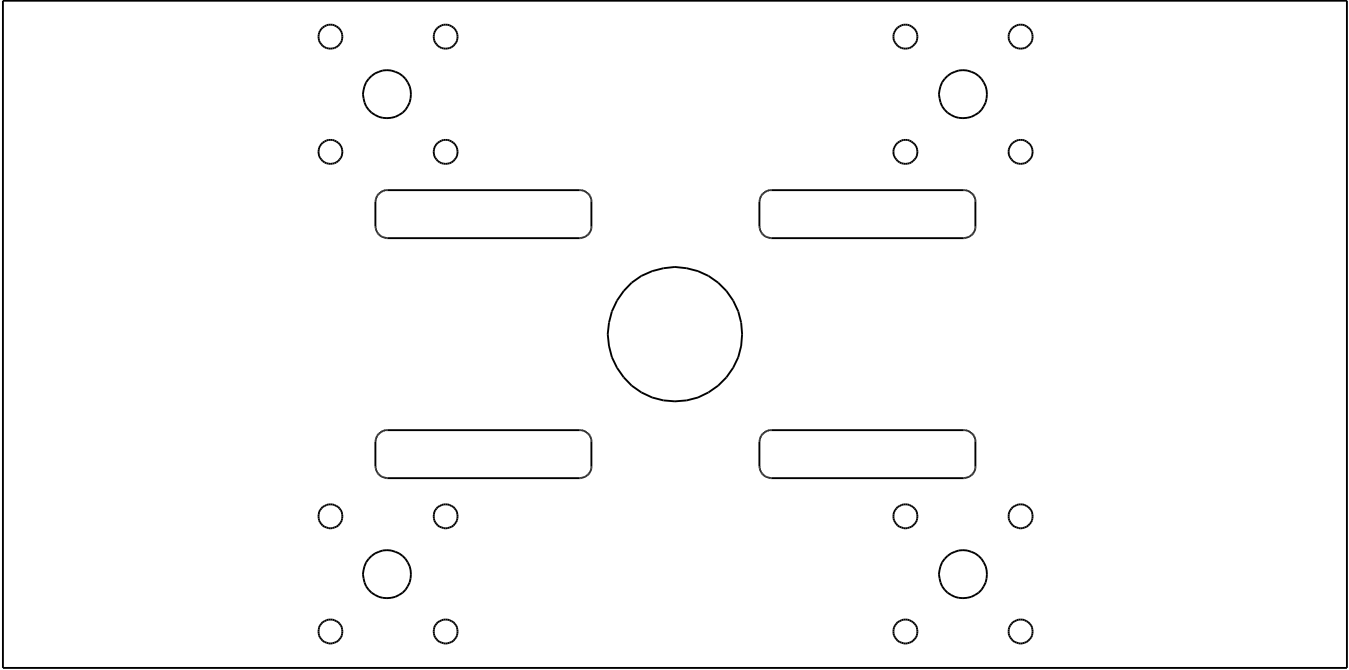

Load Plate
make 1 - .1875 thick

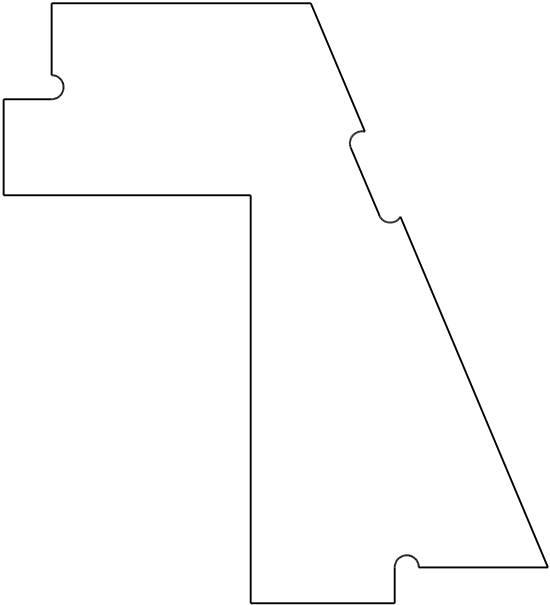

Shell Brace
make 4 - .1875 thick

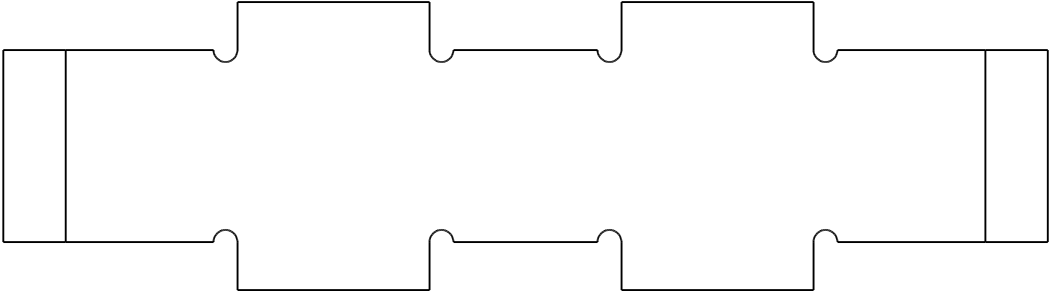

Center Strip
make 1 - .1875 thick
bevel ends at 30 degrees

CS:R SAK Center Foot - V1

Structural Components

Copyright Media-Conversions - Released for non-commercial use ONLY!

DRAWN	DATE	<div>MediaConversions</div>			
CHECKED	03/01/17				
QA					
MFG					
APPROVED		SIZE	FSCM NO.	DWG NO.	REV
		C			
		SCALE		SHEET	

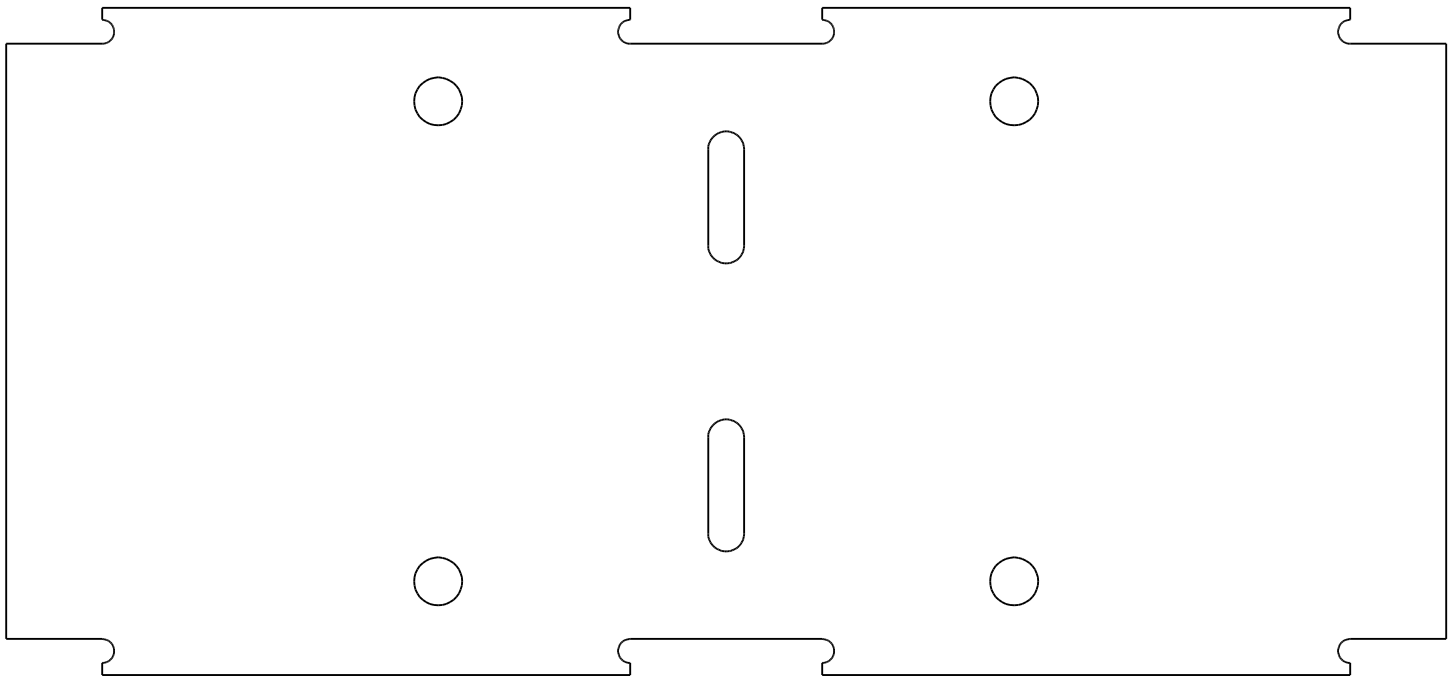

Wheel Mount Top
Make 1 - .1875 thick

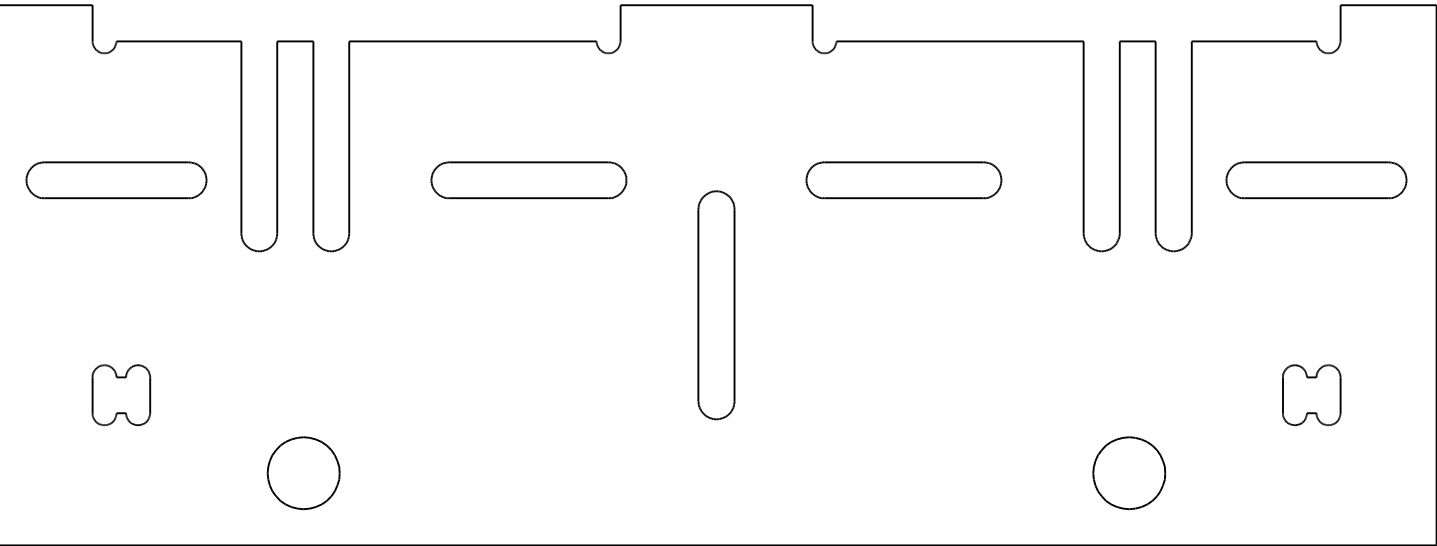

Wheel Mount Side
Make 2 - .1875 thick

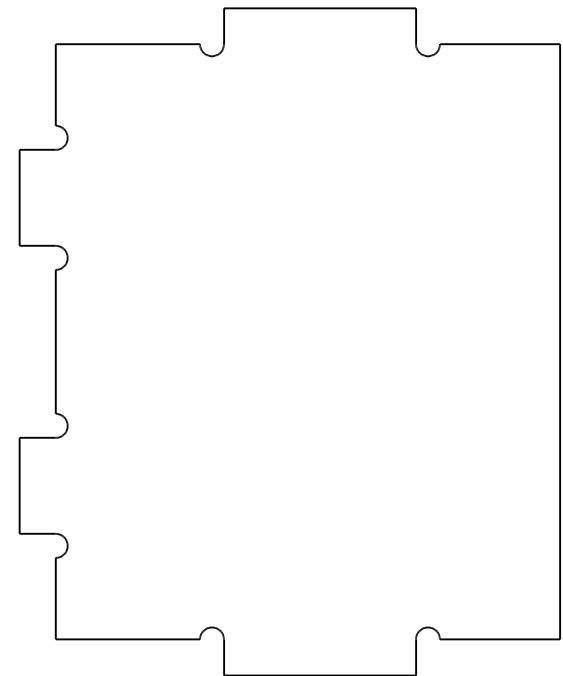

Wheel Mount Inside
Make 1 - .1875 thick

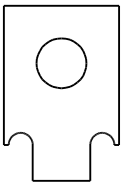

Wheel Anchor
Make 4 - .1875 thick

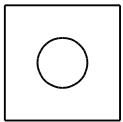

Wheel Anchor Spacer
Make 4 - .1875 thick

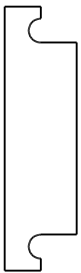

Wheel Mount Guide
Make 8 - .1875 thick

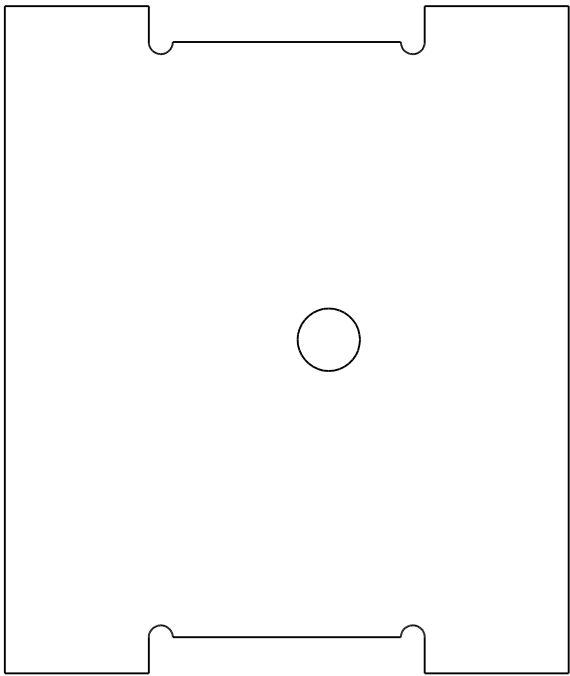

Omintrack Wheel Mount
Make 2 - .1875 thick
Only used for Omintrack
Omnicasters

CS:R SAK Center Foot - V1
Wheel Components

Copyright Media-Conversions - Released for non-commercial use ONLY!

DRAWN	DATE	<div>MediaConversions</div>			
CHECKED	03/01/17				
QA					
MFG		SIZE	FSCM NO.	DWG NO.	REV
APPROVED		C			
		SCALE		SHEET	

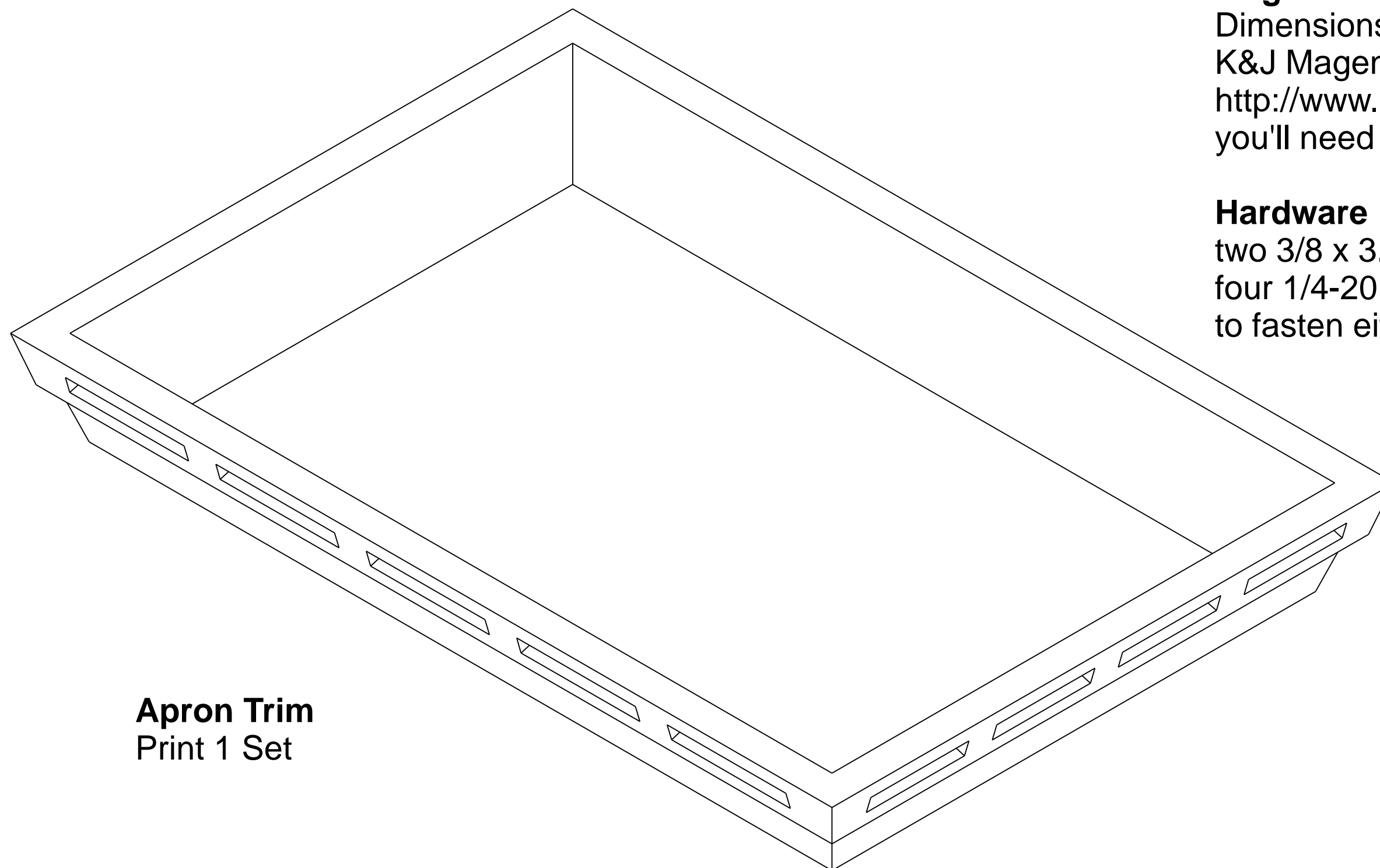

Apron Trim
Print 1 Set

Magnets

Dimensions: 3/8" dia. x 1/16" thick - Grade N52

K&J Magenetics part number D61-N52

<http://www.kjmagnetics.com/proddetail.asp?prod=D61-N52>

you'll need 8 - buy some extras! - also used in the Outer Foot Shell

Hardware

two 3/8 x 3.5 inch bolts for axels and nylock nuts (vibration proof)

four 1/4-20 x 1 inch bolts and nylock nuts -

to fasten either caster mount or wheel mounts to shell

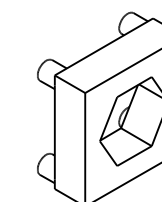

Hex Nut Trap

print 4 for Caster Version

print 8 for Vex or OmniWheel Version

Parts

Caster Version

Colson Caster 1 Series Threaded Swivel Stem Caster
with a Performa Rubber (Flat/Grey) 3 in wheel

Part # 1.03054.441 MTG55 Note: 3/8-16 1.25 in stem

I bought mine on eBay from : <http://stores.ebay.com/handtruckscastersdockplates/>
search for "Colson Swivel Stem Caster with 3" Performa TPE Gray Non-Marking Wheel"
they take best offers for 10-15% less, particularly if also buying wheels for the outer feet
at the same time (also combines shipping)

Vex Omni Wheel Version

based on work published by Kevin Holmes

<http://astromech.net/forums/showthread.php?22947-VEX-Omni-Wheels-Everything-you-need-to-know>
uses 4 inch wheels

4 x 217-2584 4" omni Wheel - <http://www.vexrobotics.com/omni-wheels.html>

4 x bearing (#2732): <http://www.vexrobotics.com/bearings.html>

1 Pack of Spacer (#3260): <http://www.vexrobotics.com/acetalspacers-vexpro.html>

Omintrack Omnicaster Version

<https://www.omnitrack.com/us/omnicaster-castors/oc50.html>

need 2 - OC55 casters

CS:R SAK Center Foot - V1

3D & Mechanical Components

Copyright Media-Conversions - Released for non-commercial use ONLY!

DRAWN	DATE				
CHECKED	03/01/17				
QA					
MFG					
APPROVED					
		SIZE	FSCM NO.	DWG NO.	REV
		C			
		SCALE		SHEET	