

Inner Leg Assembly Components

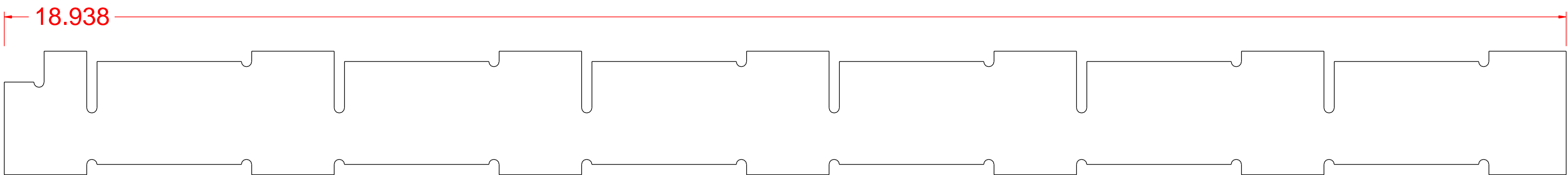

Leg Riser Main Inside - .125 thick - make 2

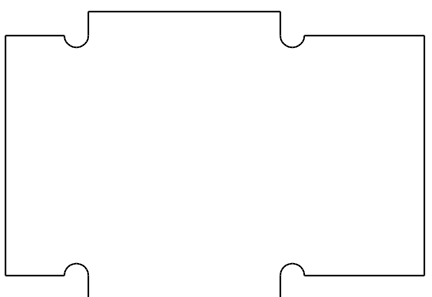

Leg Riser Arc
.125 thick
make 3

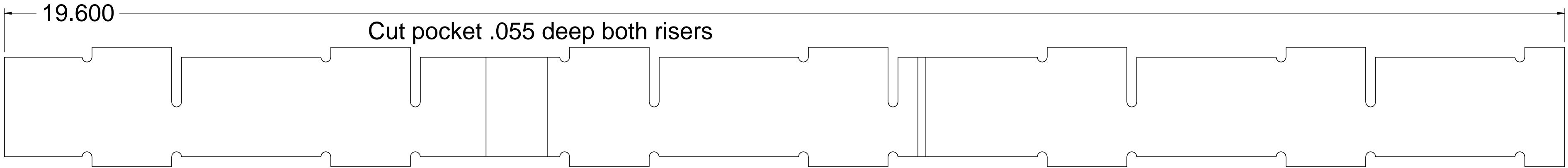

Leg Riser Main Outside Left - .125 thick - make 1 - **Note: Part Below is Mirror Image**

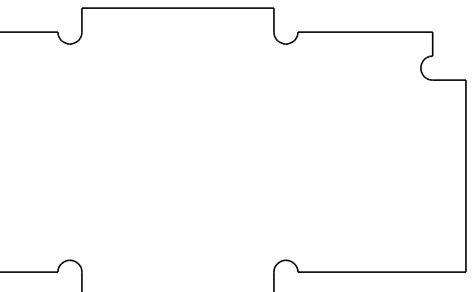

Leg Riser Arc Long
.125 thick
make 6

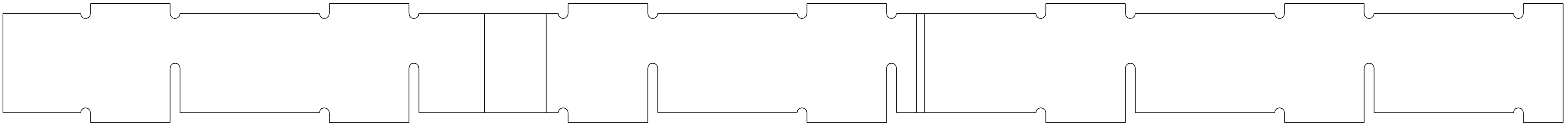

Leg Riser Main Outside Right - .125 thick - make 1

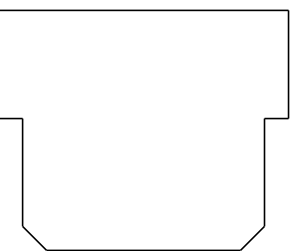

Cross Stiffener
.125 thick
make 12

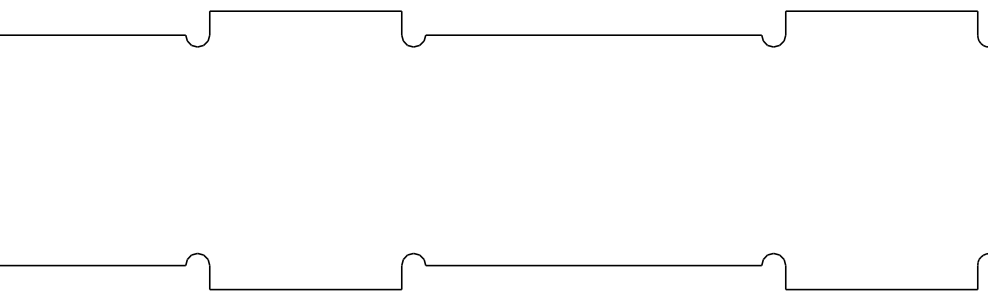

Leg Top Edge - .125 thick make 2
this part made .05 undersize

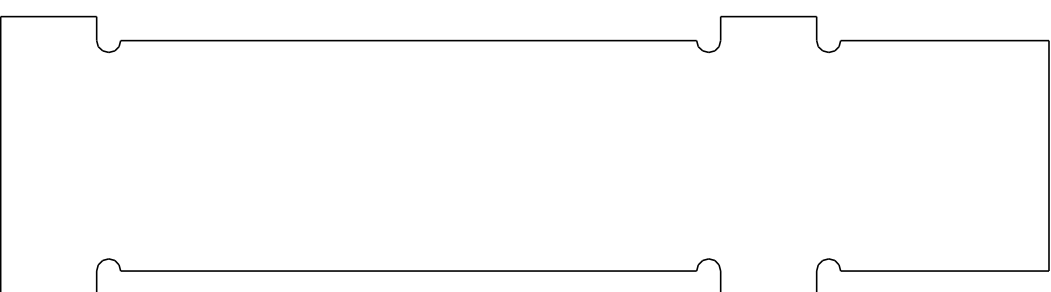

Leg Bottom Edge - .125 thick - make 2
this part made .05 undersize

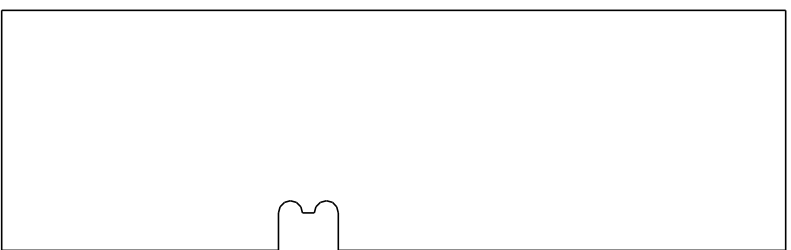

Bottom Plug - .125 thick - make 1

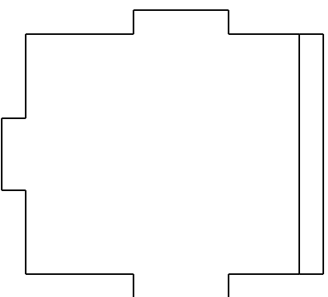

Under Shoulder
Detail 1 - .125 thick
make 2
Cut Chamfer at 45 degrees

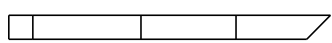

**See Assembly Instructions
The Under Shoulder Details
Will have to be filed to fit.**

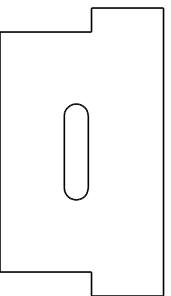

Under Shoulder
Detail 2 - .125 thick
make 2

Ankle Curve Components

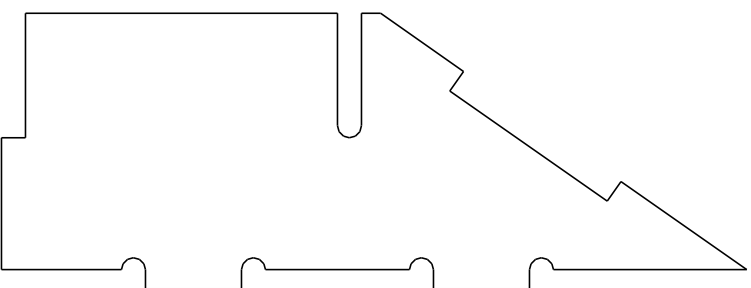

AC Rib Center
.125 thick
make 1

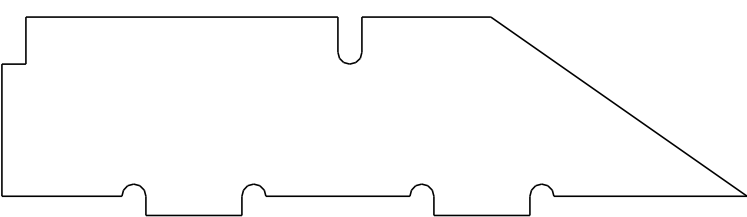

AC Rib End
.125 thick
make 2

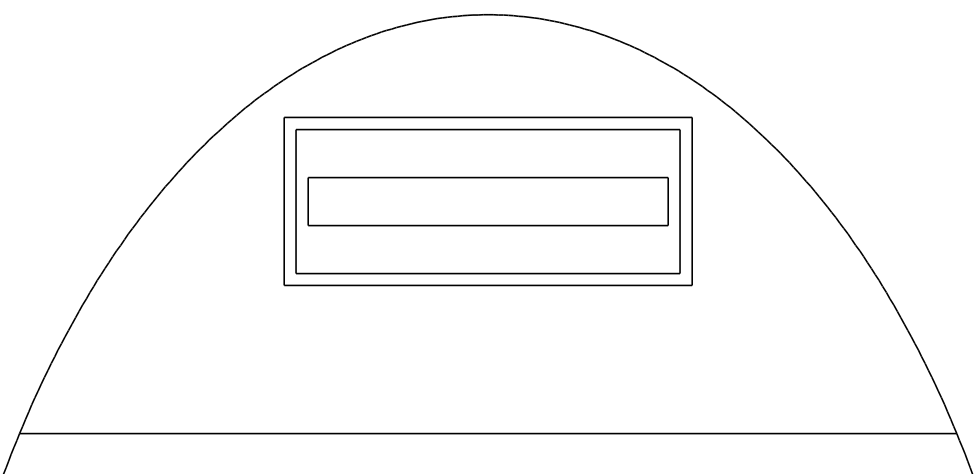

AC End - .125 thick - make 1
cut bevel at 30 degrees
Note: corners of slot must be filed square

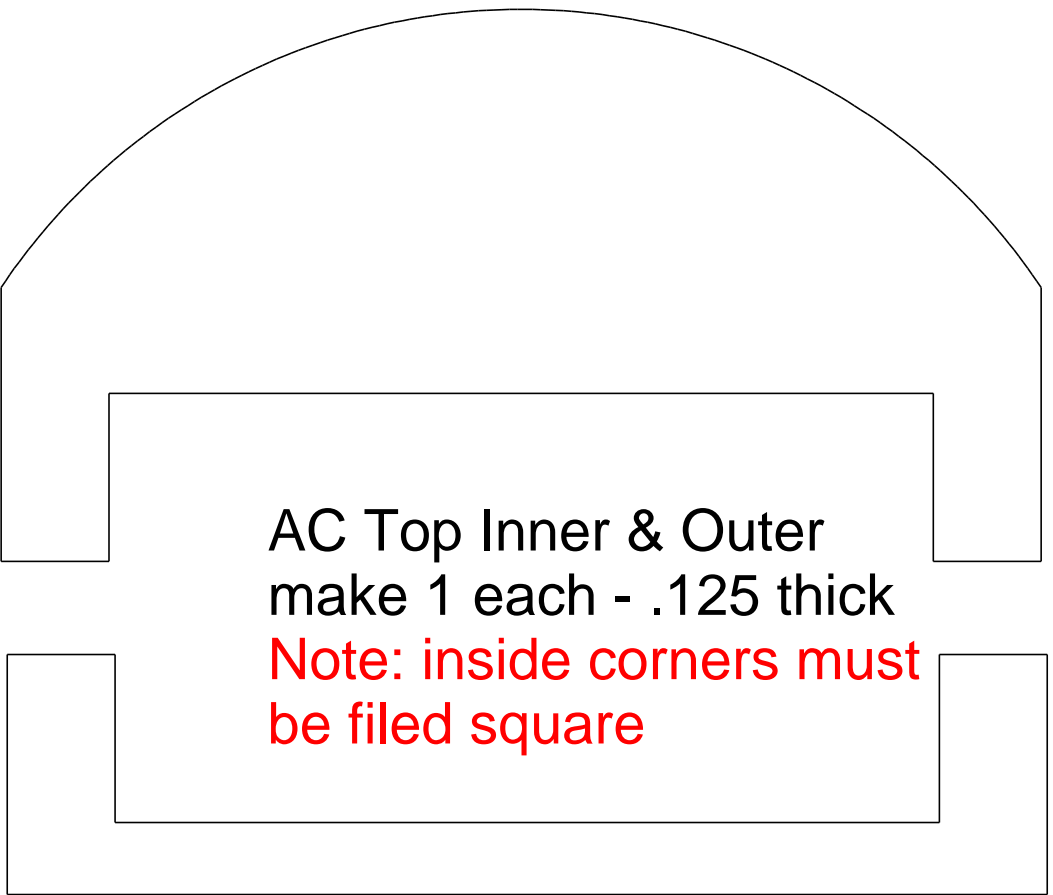

AC Top Inner & Outer
make 1 each - .125 thick
**Note: inside corners must
be filed square**

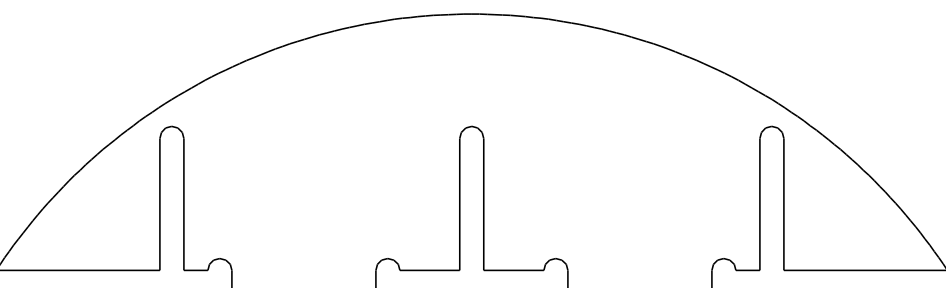

AC Ring
.125 thick
make 2



AC Patch
.125 thick
make 1

Leg Drawings pg 4/5

Copyright Media-Conversions - Released for non-commercial use ONLY!

DRAWN	DATE 1/5/2012	<div>MediaConversions</div>			
CHECKED					
QA					
MFG					
APPROVED		SIZE C	FSCM NO.	DWG NO. Box Beam Legs - Risers	REV
SCALE				SHEET	